

WORKPIECE CARRIERS

Workpiece Carrier WTD I

for light and moderate
components

Adapted for automated production

For high-precision and delicate
components

Pick-up elements (metal or plastic)
adapted to products to be carried

Made of steel, stainless steel, aluminium
or combinations

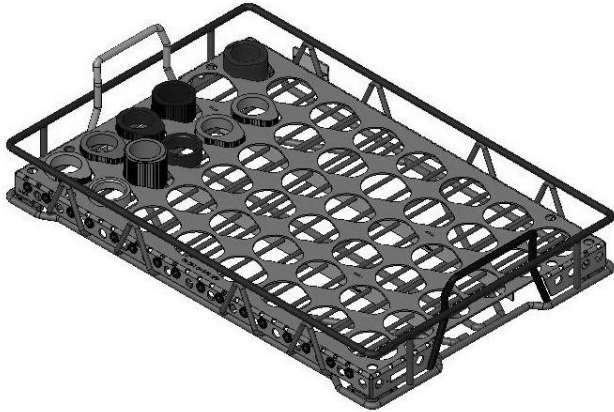

Item no. 144330

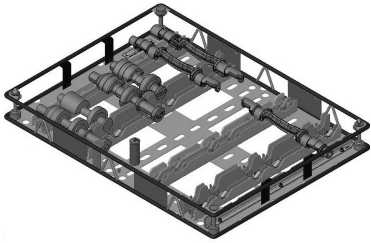

Item no. 144793

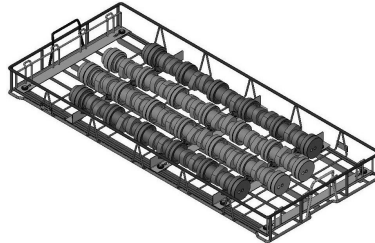

Item no. 142176

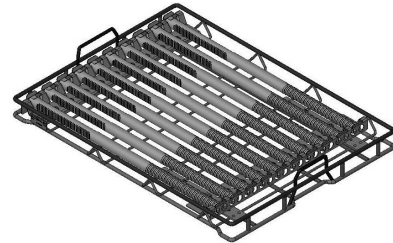

Item no. 136304

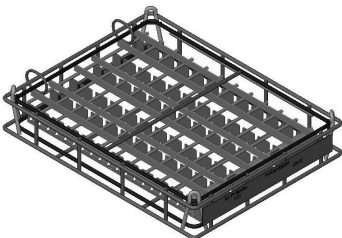

Item no. 133106

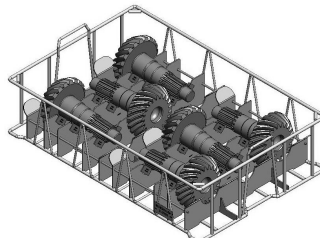

Item no. 147983

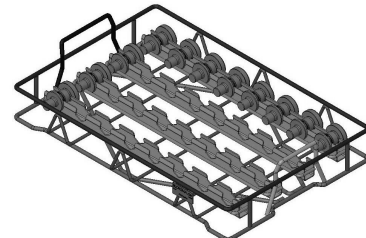

Item no. 131661

Due to the geometric shapes of the components / parts, the workpiece carriers are designed individually according to customer's requirements.

During the past 40 years, BLOKSMA has developed and produced more than 2.400 different kinds of workpiece carriers.

WORKPIECE CARRIERS

Workpiece Carrier WTD II

for light and moderate
components

Adapted for automated production

For high-precision and delicate
components

Pick-up elements (metal or plastic)
adapted to products to be carried

Made of steel, stainless steel, aluminium
or combinations

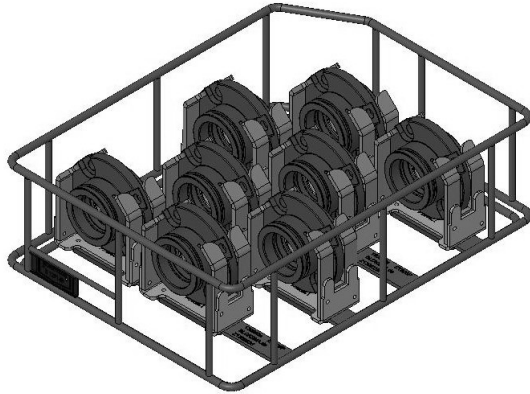

Item no. 129333

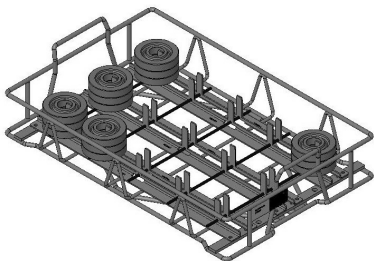

Item no. 127319

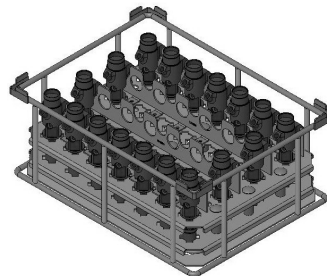

Item no. 132362

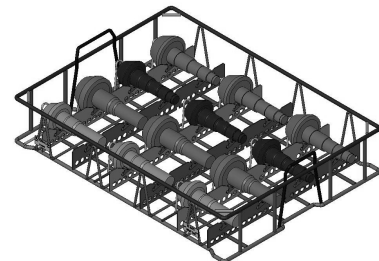

Item no. 128288

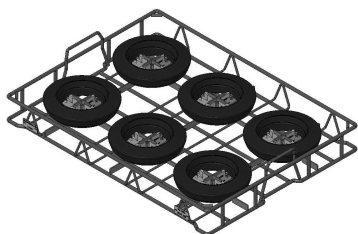

Item no. 124520

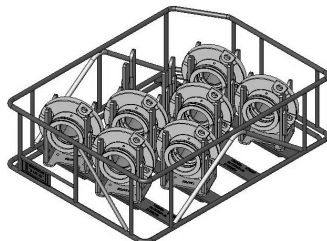

Item no. 133555

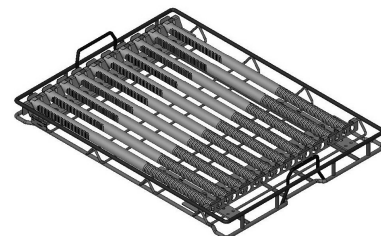

Item no. 136304

Due to the geometric shapes of the components / parts, the workpiece carriers are designed individually according to customer's requirements.

During the past 40 years, BLOKSMA has developed and produced more than 2.400 different kinds of workpiece carriers.

WORKPIECE CARRIERS

Workpiece Carrier Universal 600 x 400 mm Wire-Metal Sheet Combination

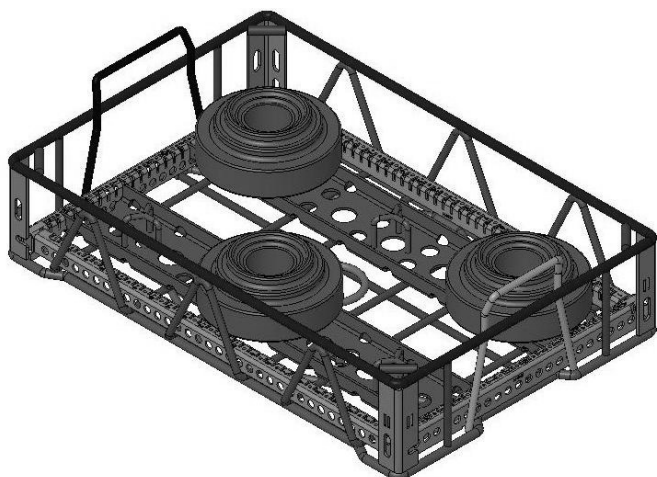

Suitable for automated production

Very high positioning accuracy

Good washing properties

Pick-up elements (metal or plastic)
adapted to products to be carried

Made of steel, stainless steel, aluminium
or combinations

Item no.	WPC-size	Remarks
202864-090-A	600 x 400 x 90 mm	Grid strips in the X- and Y-axis
202864-130-A	600 x 400 x 130 mm	Grid strips in the X- and Y-axis
202864-200-A	600 x 400 x 200 mm	Grid strips in the X- and Y-axis

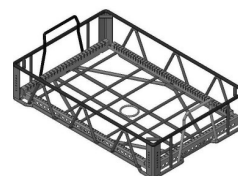

Example: 202864-090-A, stack height 90 mm, Pitch A = 12,50 mm

Item no.	WPC-size	Remarks
xxxxxx	600 x 400 mm	Receiving profiles are customized.

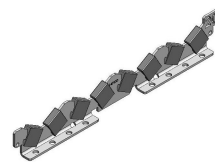

WORKPIECE CARRIERS

Workpiece Carrier Universal 800 x 600 mm Wire-Metal Sheet Combination

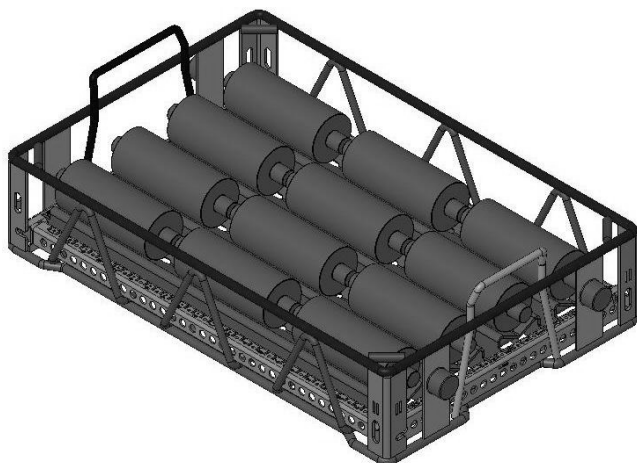

Suitable for automated production

Very high positioning accuracy

Good washing properties

Pick-up elements (metal or plastic)
adapted to products to be carried

Made of steel, stainless steel, aluminium
or combinations

Item no.	WPC-size	Remarks
202871-090-A	800 x 600 x 90 mm	Grid strips in the X- and Y-axis
202871-130-A	800 x 600 x 130 mm	Grid strips in the X- and Y-axis
202871-200-A	800 x 600 x 200 mm	Grid strips in the X- and Y-axis

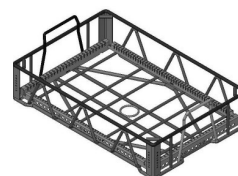

Example: 202871-090-A, stack height 90 mm, Pitch A = 12,50 mm

Item no.	WPC-size	Remarks
xxxxx	800 x 600 mm	Receiving profiles are customized

